

William Saunders is the trading name of Wm Saunders Partnership LP. Wm Saunders Partnership Limited Liability Partnership is registered in England and Wales with the Registration Number OC 308323. The Registered Office is Sheppard Lockton House, Calverton Way, Newark on Trent, Notts, NG24 2TN.

This drawing & any design thereon is the copyright of Wm Saunders Partnership LP and must not be reproduced without their written consent.

Contractors must verify all dimensions, levels and co-ordinates of the site before commencing any work or making any shop drawings: no dimensions to be taken from drawing.

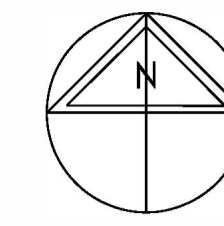

Key:

- Adoptable tarmac carriageway
- Adoptable tarmac footway
- Site Boundary
- S38 Boundary
- Highway Gully & Connection
- S104 Surface Water Sewer
- S104 Foul Sewer
- Tactile Crossing Point

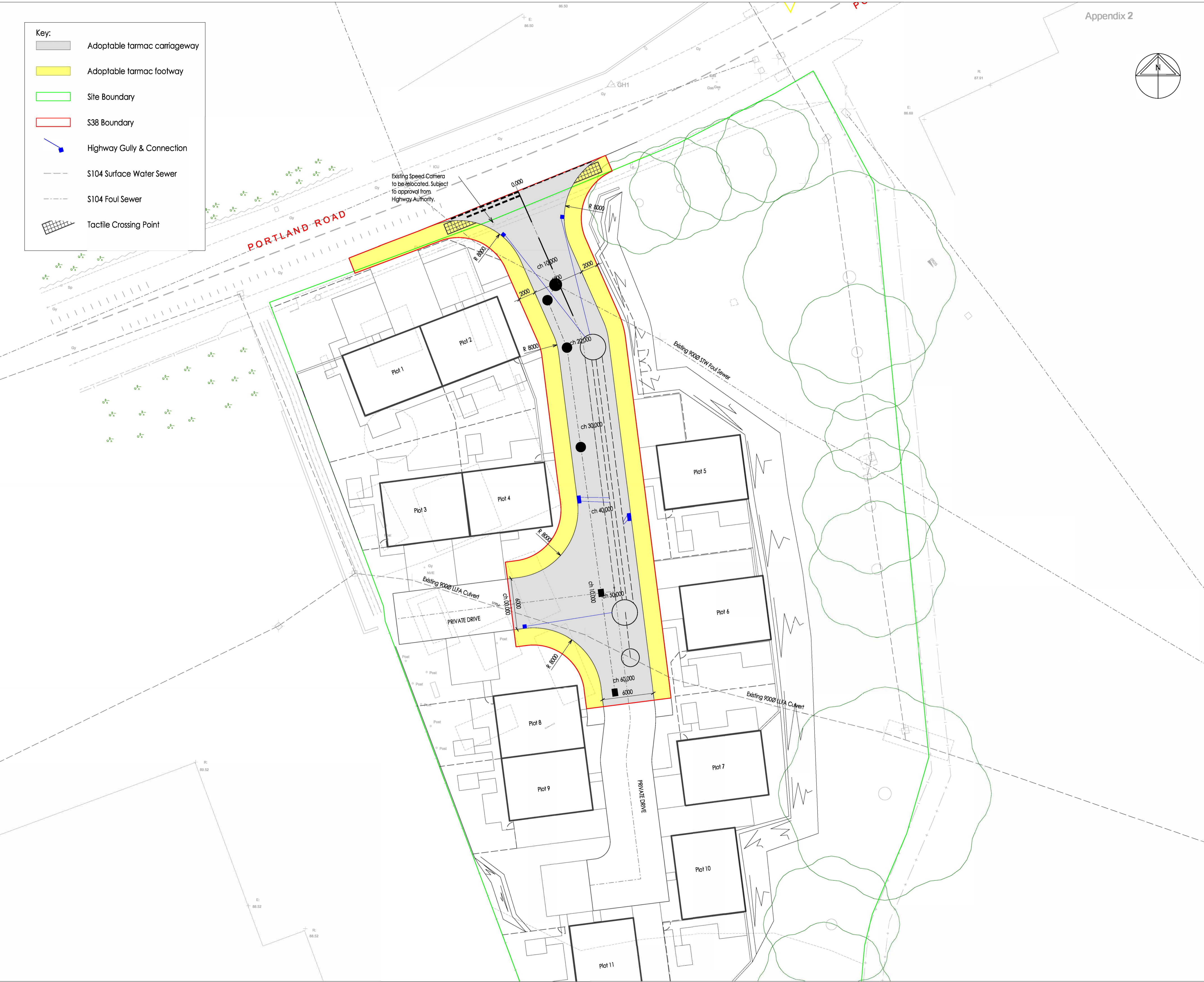

- Notes:**
1. Drawing to be read in conjunction with all other relevant S38, Engineers and Architects details.
 2. All works within the Public Highway must comply with the current Health and Safety standards and all signing to comply with Chapter 8 traffic safety measures and signs for roadworks and temporary situations of the traffic manual.
 3. All works to be constructed in accordance with the requirements of the Derbyshire County Council's Design Guide 'Delivering Streets and Places'.
 4. It is the Contractor's responsibility to locate existing utilities where they may be affected by the works.
 5. All connections to road gullies to be 150mm diameter.
 6. All trenches within adoptable highways to be backfilled with Type 1 granular material.
 7. Gully tops to be heavy duty ductile iron grade D400 to BS EN 124 with captive hinges.

P2	Drawing title updated	CM		20/04/22
P1	Issued for Technical Approval	CM	AG	11/04/22
Rev	Description	Drn	Vfd	Date

As outlined in section 2.3 of the CIB Industry Guidance to Designers, insignificant risks can usually be ignored, as can risks arising from routine construction activities, unless the design compounds or significantly alters these risks. In accordance with CDM Regulations 8, 9 and 11, any significant risks relating to the design features shown on this drawing have been identified and are annotated thus:

- No significant risks have been identified.
- Significant risks have been identified - refer to notes on drawing for information on residual risks and any control measures to be employed.

Refer to the current Designer's Risk Assessment sheets for further details.

Designer's Signature: CM Date: 03/22

Drawing Status: APPROVAL

williamsaunders
 architecture: engineering: building consultancy

Sheppard Lockton House Tel: 01636 704361
 Calverton Way Fax: 01636 702809
 Newark-on-Trent W: wm-saunders.co.uk
 Nottinghamshire, NG24 2TN

Also at Leeds, Lincoln, Warkworth

Project	Market Close (Site 1) Shirebrook, Mansfield		
Client	Robert Woodhead Ltd		
Title	Section 38 Layout - North		
WmS Project Ref:	Drawn	Date	Scale
12213/02	CM	31/03/22	1:200 @ A1
Drawing/Document Reference			
Project	Originator	Zone	Level
12213 - WMS - 02 - XX - DR - C - 39501 - S8 - P2			

Key:

- Adoptable tarmac carriageway
- Adoptable tarmac footway
- Site Boundary
- S38 Boundary
- S278 Boundary
- Highway Gully & Connection
- S104 Surface Water Sewer
- S104 Foul Sewer
- Tactile Crossing Point



Williams Saunders is the trading name of Wm Saunders Partnership LLP. Wm Saunders Partnership Limited Liability Partnership is registered in England and Wales with the Registration number OC 39822. The Registered Office is Sheppard Lockton House, Cafferata Way, Newark on Trent, Notts, NG24 2JN.

This drawing & any design thereon is the copyright of Wm Saunders Partnership LLP and must not be reproduced without their written consent.

Contractors must verify all dimensions, levels and co-ordinates of the site before commencing any work or making any shop drawings: no dimensions to be taken from drawing.

- Notes:**
1. Drawing to be read in conjunction with all other relevant S38, Engineers and Architects details.
 2. All works within the Public Highway must comply with the current Health and Safety standards and all signing to comply with Chapter 8 traffic safety measures and signs for roadworks and temporary situations of the traffic manual.
 3. All works to be constructed in accordance with the requirements of the Derbyshire County Council's Design Guide 'Delivering Streets and Places'.
 4. It is the Contractor's responsibility to locate existing utilities where they may be affected by the works.
 5. All connections to road gullies to be 150mm diameter.
 6. All trenches within adoptable highways to be backfilled with Type 1 granular material.
 7. Gully tops to be heavy duty ductile iron grade D400 to BS EN 124 with captive hinges.

PI	Issued for Technical Approval	CM		20/04/22
Rev	Description	Drm	Vfd	Date
<p>As outlined in section 2.3 of the CIB Industry Guidance to Designers, insignificant risks can usually be ignored, as can risks arising from routine construction activities, unless the design compounds or significantly alters these risks. In accordance with CDM Regulations 8, 9 and 11, any significant risks relating to the design features shown on this drawing have been identified and are annotated thus: </p> <p><input checked="" type="checkbox"/> No significant risks have been identified.</p> <p><input type="checkbox"/> Significant risks have been identified - refer to notes on drawing for information on residual risks and any control measures to be employed.</p> <p>Refer to the current Designer's Risk Assessment sheets for further details.</p>				
Designer's Signature		CM	Date 03/22	

Drawing Status **APPROVAL**

williamsaunders
 architecture: engineering: building consultancy

Sheppard Lockton House Tel: 01636 704361
 Cafferata Way Fax: 01636 702809
 Newark-on-Trent W: wms-saunders.co.uk
 Nottinghamshire, NG24 2JN

Also at Leeds, Lincoln, Warkworth

Project			
Market Close (Site 1) Shirebrook, Mansfield			
Client			
Robert Woodhead Ltd			
Title			
Section 38 & Section 278 Layout - South			
WMS Project Ref.	Drawn	Date	Scale
12213/02	CM	19/04/22	1:200 @ A1
Drawing/Document Reference			
Project	Originator	Zone	Level
12213 - WMS - 02 - XX - DR - C - 39511 - S8 - P1			